

## **AGENDA**

### **COMMITTEE ON PUBLIC SAFETY, HEALTH AND TRAFFIC**

**March 7, 2011**  
**Aldermen Roy, Osborne,**  
**Long, Ouellette, Shaw**

**4:30 PM**  
**Aldermanic Chambers**  
**City Hall (3<sup>rd</sup> Floor)**

1. Chairman Roy calls the meeting to order.
2. The Clerk calls the roll.
3. The Traffic Division and Parking Division have submitted an agenda which needs to be addressed:

**RESCIND RESIDENT PARKING ONLY DURING SCHOOL HOURS –  
EMERGENCY ORDINANCE:**

On Maple Street, east side, from Bridge Street to a point 120 feet south  
(Ord. 9989)  
Alderman Roy

**RESIDENT PARKING ONLY DURING SCHOOL HOURS –  
EMERGENCY ORDINANCE:**

On Maple Street, east side, from a point 30 feet south of Bridge Street to a point  
46 feet south  
Alderman Roy

**TWO HOUR PARKING MONDAY-FRIDAY – 8:00 AM-5:00 PM  
EMERGENCY ORDINANCE:**

On Maple Street, east side, from a point 76 feet south of Bridge Street to a point  
44 feet south  
Alderman Roy

**TRAFFIC SIGNALS - UNION STREET AND WEBSTER STREET:**

On Webster Street, install protected/permissive (green left arrow) signals –  
eastbound and westbound  
Alderman Craig  
Alderman Long  
Alderman Ludwig

**STOP SIGN:**

On Smyth Road (Extension to Holmes Drive) at Smyth Road – NWC  
Alderman Craig

**NO PARKING ANYTIME:**

On Cypress Street, east side, from Auburn Street to a point 50 feet south  
Alderman Osborne

**RESCIND NO PARKING TOW ZONE (ANYTIME):**

Amherst Street, both sides, from Ash Street to Beech Street  
ORD 8643  
Alderman Roy

**NO PARKING TOW ZONE MONDAY-FRIDAY – 6:00 AM-4:00 PM:**

Amherst Street, both sides, from Ash Street to Beech Street  
Alderman Roy

**NO PARKING ANYTIME – TURN AROUND EASEMENT:**

West Rosemont Avenue at #256, 16 feet wide and southerly a distance of 30 feet,  
both sides

Alderman Shaw

*(Note: Referred by the Board of Mayor and Aldermen on January 25, 2011)*

4. Communication from Alderman Greazzo regarding policies and procedures related to snow emergencies.  
**Ladies and Gentlemen, what is your pleasure?**
5. Communication from Alderman Arnold related to animal cruelty ordinances.  
**Ladies and Gentlemen, what is your pleasure?**
6. Update from Chief Burkush on fire protection from Insurance Services Office, if available.  
**Ladies and Gentlemen, what is your pleasure?**
7. Communication from Brandy Stanley, Parking Manager, submitting a request on behalf of Millennium Running for free parking to race registrants in the Victory Garage on Friday, March 25, 2011, from 3:00 p.m. to 10:00 p.m.  
**Ladies and Gentlemen, what is your pleasure?**

8. Communication from Brandy Stanley, Parking Manager, submitting a request on behalf of MCCI for an extension of discounted commercial parking on Elm Street.  
**Ladies and Gentlemen, what is your pleasure?**
9. Communication from Linda Connell of McLane Law Firm, requesting a directional sign be placed in the City right-of-way at the northeast corner of South Willow Street and South Porter Street.  
*(Note: A letter from an abutter objecting to this request is attached.)*  
**Ladies and Gentlemen, what is your pleasure?**

### **TABLED ITEMS**

***A motion is in order to remove any item from the table.***

10. Discussion regarding a revised Ordinance proposal related to commercial motor vehicles.  
*(Note: Tabled 1/3/2011; the Parking Division, Traffic Division and City Solicitor to meet with Committee representatives.)*
11. Communication from Joseph Parrotto, Beaver Street resident, regarding traffic issues in the area of Candia Road and Hanover Street.  
*(Note: Retabled 1/3/2011 with a recommendation to be submitted by NHDOT. Originally tabled 12/6/2010. A review from NHDOT is attached.)*
12. There being no further business, a motion is in order to adjourn.



**CITY OF MANCHESTER**  
*Board of Aldermen*

MEMORANDUM

TO: Chairman Jim Roy  
Committee on Public Safety, Health & Traffic

FROM: Alderman Phil Greazzo *AG*  
Ward 10

RE: Policies & Procedures Related to a Snow Emergency

DATE: February 15, 2011

On February 1, 2011, the Board of Mayor and Aldermen voted to waive the towing fees associated with a vehicle stolen in Bedford and belonging to a Goffstown resident. The vehicle, left on a Manchester street, was towed during a snow emergency to the City's impound lot along with one hundred and twenty-one other vehicles. During the declaration of a snow emergency, it remains the priority of the Manchester Police Department to assist the Highway Department in removing illegally parked vehicles off City streets which in turn, allows Highway personnel to safely and efficiently plow our neighborhoods. It is not their priority during a snow emergency to determine the location of these vehicle owners.

I feel that this Board may have set a dangerous precedent for the hundreds of vehicles towed during snow emergencies annually. I am respectfully requesting that your committee review the City's existing policies and procedures for towing vehicles during a snow emergency and implement the necessary changes. Thank you.

pc: Board of Mayor and Aldermen

In Board of Mayor and Aldermen

Date: 2/15/11

On motion of Ald. Greazzo

Seconded by Ald. Roy

Voted to refer to the Committee on  
Public Safety, Health and Traffic.

*Matthew J. Harman* City Clerk



**CITY OF MANCHESTER**  
*Board of Aldermen*

**M E M O R A N D U M**

To: Board of Mayor and Aldermen      **In Board of Mayor and Aldermen**  
Date: 3/1/11  
From: Alderman Patrick Arnold *PA*      **On motion of Ald. Arnold**  
Seconded by Ald. Shea  
Voted to refer to the Committee on Public  
Date: March 1, 2011      **Safety, Health and Traffic.**  
*Patrick Sheehan* City Clerk  
Re: Organized dog fighting in Manchester

Recently, a constituent called me with concerns over organized dog fighting activities in the City of Manchester. I consulted with law enforcement officers, and it disturbed me to learn that such activities are indeed occurring in our community. Surely you agree that this heinous cruelty and abuse should be investigated and prosecuted to the full extent of the law.

To address this problem, I respectfully request that this Board evaluate the applicability and enforceability of any and all current ordinances that are relevant (e.g. gambling restrictions, humane treatment of animals). I further request that we consider whether any existing ordinances should be revised or any new ordinances enacted to enhance law enforcement efforts.

Thank you for your consideration of this matter.



# **CITY OF MANCHESTER**

## **PARKING DIVISION**

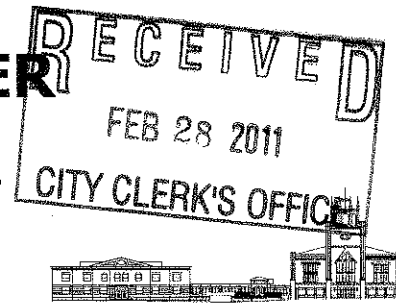

Brandy Stanley  
Parking Manager  
bstanley@manchesternh.gov

**February 7, 2011**

**Chairman Jim Roy  
Committee on Public Safety & Traffic  
1 City Hall Plaza  
Manchester, NH 03101**

**Re: Shamrock Shuffle Request for Free Parking**

**Dear Chairman Roy:**

**Attached please find a request from Millenium Running for free parking to racer registrants in the Victory Garage on Friday, March 25<sup>th</sup> from 3pm-10pm.**

**Should the committee approve this request, we would allow race registrants to exit the garage free of charge upon presentation of their race number.**

**The Parking Division has no issues with this request and respectfully requests passage of the attached request.**

**Please do not hesitate to contact me should you have any questions.**

**Sincerely,**

**Brandy Stanley  
Parking Manager  
City of Manchester**

**CC: William Sanders**



Millennium Running, LLC  
John Mortimer  
PO Box 366  
Grantham, NH 03753  
[jmortiii@gmail.com](mailto:jmortiii@gmail.com)  
603-512-1976

Date: February 7, 2011

To: Brandy Stanley, City of Manchester Parking Division

From: John Mortimer, Shamrock Shuffle Race Director

Re: Shamrock Shuffle Road Race free parking for # pick-up at Victory Garage

---

Dear Brandy:

Please find outlined a request to allow for free parking at the Victory Garage on Friday, March 25, 2011 from 3pm to 10pm for participants of the Manchester Shamrock Shuffle Road Race. The race details are as follows:

### ***Shamrock Shuffle***

*An Irish theme 2-mile road race that kicks off the St. Patrick's Parade in downtown Manchester, NH*

**Sunday, March 27, 2011**

**11am race / 12pm parade**

Veteran's Park - Manchester, New Hampshire

[www.manchestershuffle.com](http://www.manchestershuffle.com)

**Early Pick-up:** At Runner's Alley (36 Hanover St., Manchester, NH) from 3pm to 7pm on Friday & Saturday, March 25th and 26th. You may also register in-person at Early Pick-up.

We humbly request to offer **Free Parking at the Victory Garage to each person picking up their number on Friday March 25, 2007 between 3pm and 10pm.** We would advertise that runners may park in the Victory Garage and be let out free of charge when they present their bib # upon exiting. The goal is that participants (and their guest/families/significant others') would visit our generous race sponsors that are providing incentives to registrants to stay and have dinner after picking up their number.

Please let me know if any further steps are required to help with this promotion of bringing customers to downtown Manchester.

Thank you,

John Mortimer



# **CITY OF MANCHESTER**

## **PARKING DIVISION**

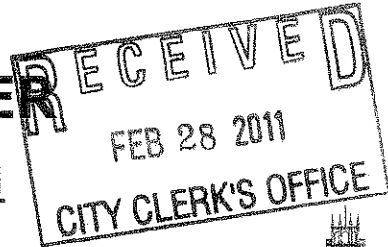

Brandy Stanley  
Parking Manager  
bstanley@manchesternh.gov

**February 28, 2011**

**Chairman Jim Roy  
Committee on Public Safety & Traffic  
1 City Hall Plaza  
Manchester, NH 03101**

**Re: Request for Extension of Discounted Parking**

**Dear Chairman Roy:**

**Attached please find a request from MCCI for an extension of discounted commercial parking on Elm Street. MCCI is the contractor for a new building being constructed at 973 Elm Street.**

**The current rate for commercial (reserved) parking spaces is \$15 per space per day. An analysis of the parking spaces in question shows that each space produces approximately \$8.00 per space per day in revenue, and MCCI is requesting that they be allowed to purchase a total of 12 reserved spaces at that rate until April 29<sup>th</sup>, 2011.**

**The approval on file from the Board of Mayor and Aldermen is for a total of 4 spaces until March 31, 2001.**

**Please do not hesitate to contact me should you have any questions.**

**Sincerely,**

*Brandy Stanley*

**Brandy Stanley  
Parking Manager  
City of Manchester**

**CC: William Sanders  
Stephanie Lewry**



**Stanley,Brandy**

**From:** Steven Freeman [steven@mcci-nh.com]  
**Sent:** Thursday, February 24, 2011 10:58 AM  
**To:** Stanley,Brandy  
**Subject:** RE: Happy New Year

Brandy, I have requests for two more confirmed for the duration.  
 I am going to assume a few more would be requested.  
 If possible, request approval for six with two being committed and four reserved.  
 I think they expire end of march, I would ask to extend that to April 29, 2011.

Thank you, as always for your help and kindness.  
 Steven.

All the Best!



Steven J. Freeman  
 Design & Project Manager  
 MCCI - Mark Carrier Construction, Inc.  
 175 Lincoln Street, Suite 101  
 Manchester, NH 03103-5031  
 Phone: 603-627-9506  
 Fax: 603-647-2270  
 Email: Steven@mcci-nh.com  
<http://www.mcci-nh.com/>

**From:** Stanley,Brandy [mailto:BStanley@manchesternh.gov]  
**Sent:** Tuesday, January 04, 2011 8:50 AM  
**To:** Steven Freeman  
**Subject:** RE: Happy New Year

You tell us how many spaces you want and for what period of time. Typically in situations like yours, we'll bill you monthly for the spaces. We will issue you permits for display (or storage onsite in case someone asks, since you can't put a permit on a crane or in an empty space) that will expire at the end of every month, so you'll need to come in and re-up your permits each month. Once you get the permits, you can block them off however you like - sawhorses, cones, any other type of barrier. I do have some portable no parking signs, but I don't have all that many and tying them up for 4 months might be problematic.

B

**From:** Steven Freeman [mailto:steven@mcci-nh.com]

2/28/2011

**Sent:** Tuesday, January 04, 2011 8:48 AM  
**To:** Stanley, Brandy  
**Subject:** RE: Happy New Year

Can you refresh for me please?  
 What is the device I am buying? Is it a monthly rental or daily or other 4 month?  
 What do we get to display or does your dept. put a sign that reserves the spaces?

Thank You.

All the Best!



Steven J. Freeman  
 Design & Project Manager  
 MCCI - Mark Carrier Construction, Inc.  
 175 Lincoln Street, Suite 101  
 Manchester, NH 03103-5031  
 Phone: 603-627-9506  
 Fax: 603-647-2270  
 Email: Steven@mcci-nh.com  
<http://www.mcci-nh.com/>

**From:** Stanley, Brandy [mailto:BStanley@manchesternh.gov]  
**Sent:** Tuesday, January 04, 2011 8:34 AM  
**To:** Steven Freeman  
**Subject:** RE: Happy New Year

Sorry, Steve – I forgot to tell you. This was all approved in December. If you would come into our office and make arrangements for the spaces, you can take possession of them whenever you like.

**From:** Steven Freeman [mailto:steven@mcci-nh.com]  
**Sent:** Tuesday, January 04, 2011 8:22 AM  
**To:** Stanley, Brandy  
**Subject:** Happy New Year

Hi Brandy,  
 Happy New Year.  
 Do you have a meeting tonight about my request for parking spaces?

This Thursday 1.6.11 from 12:01AM until 8AM, I will be erecting steel on elm st in front of 971 Elm, our jobsite.  
 Can you have that area posted so that we can use it in the overnight?  
 Thank You.

2/28/2011

All the Best!

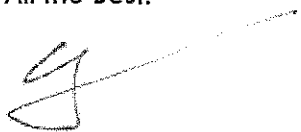

**Steven J. Freeman**

Design & Project Manager

MCCI - Mark Carrier Construction, Inc.

175 Lincoln Street, Suite 101

Manchester, NH 03103-5031

Phone: **603-627-9506**

Fax: 603-647-2270

Email: [Steven@mcci-nh.com](mailto:Steven@mcci-nh.com)

<http://www.mcci-nh.com/>

2/28/2011



McLane, Graf,  
Raulerson & Middleton  
Professional Association

900 Elm Street | P.O. Box 326 | Manchester, NH 03105-0326  
Tel: 603.625.6464 | Fax: 603.625.5650 | [www.mclane.com](http://www.mclane.com)

OFFICES IN:  
MANCHESTER  
CONCORD  
PORTSMOUTH  
WOBURN, MA

LINDA C. CONNELL  
Direct Dial: (603) 628-1310  
Email: [linda.connell@mclane.com](mailto:linda.connell@mclane.com)  
Licensed in NH

February 28, 2011

**FOR HAND DELIVERY**

Matthew Normand, City Clerk  
Office of the City Clerk  
City of Manchester  
One City Hall Plaza  
Manchester, NH 03101

**Re: Proposal for Consideration by Public Safety/Traffic Committee  
and Board of Mayor and Aldermen**

Dear Mr. Normand:

I am enclosing a proposed directional sign for location in the City right-of-way at the northeast corner of South Willow Street and South Porter Street and plans showing the proposed location of the sign. The second plan also includes information on locations of utilities in that area of the public right-of-way.

We represent Bedford Wellness Realty, LLC and its tenant, The Workout Club. Bedford Wellness Realty, LLC has a conditional purchase and sale agreement for the property located at 1300 South Porter Street, which it proposes to lease, in part, to The Workout Club. This sign is intended to address the difficulty in readily locating South Porter Street from South Willow Street.

We would like to be placed on the agenda of the Public Safety/Traffic Committee at its next meeting, which we understand is on March 7, 2011 and on the meeting of the Board of Mayor and Aldermen on March 15, 2001.

Thank you for your attention to this. Please let me know if there are any questions.

Sincerely,

Linda C. Connell

LCC:pgs  
Enclosure

4663711\_1  
February 28, 2011 4:23:08 PM

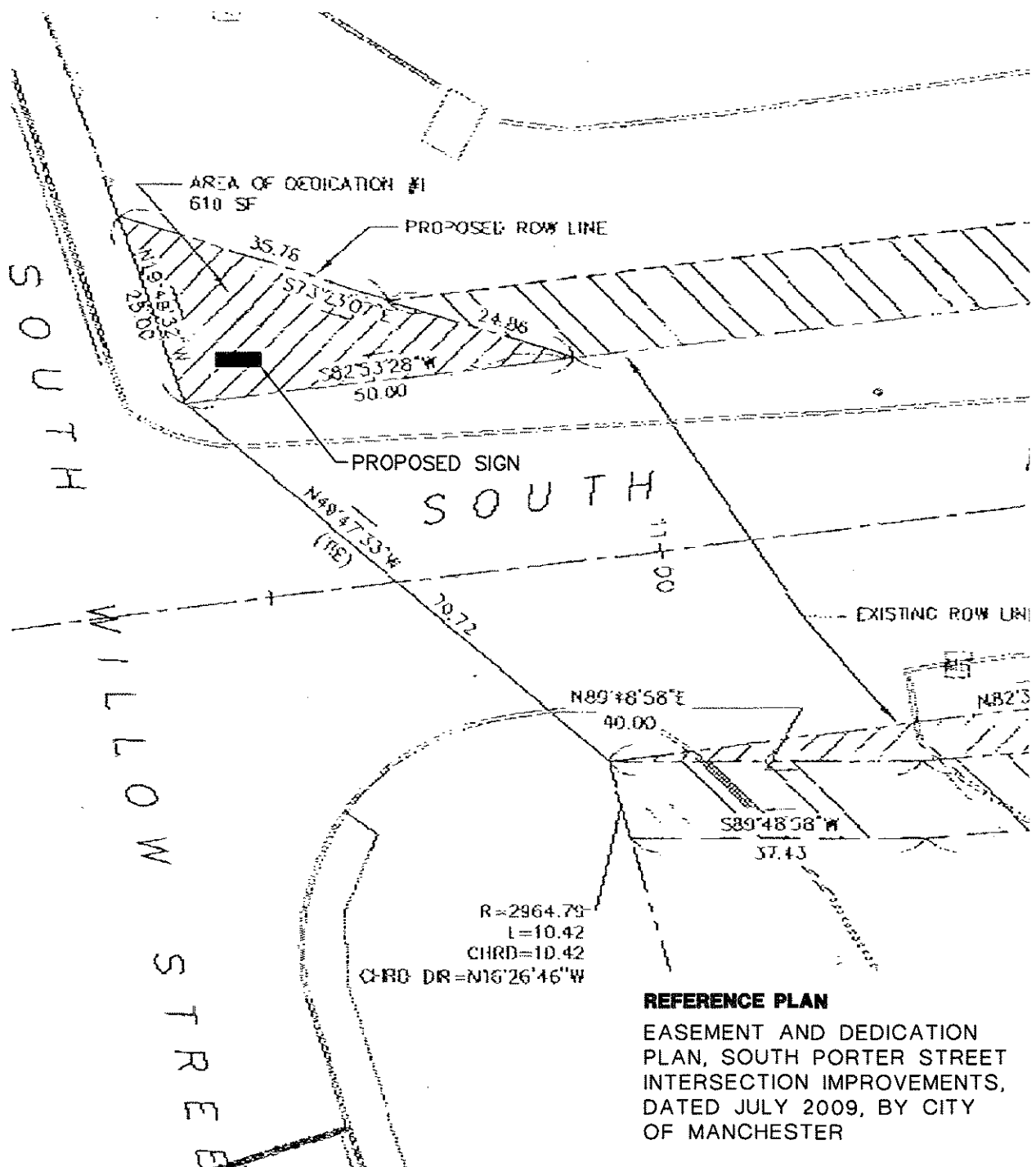

# **REFERENCE PLAN**

EASEMENT AND DEDICATION  
PLAN, SOUTH PORTER STREET  
INTERSECTION IMPROVEMENTS,  
DATED JULY 2009, BY CITY  
OF MANCHESTER

## **SK-1 PROPOSED SIGN LOCATION**

**SCALE: 1"=20'**



Civil Engineers  
Structural Engineers  
Traffic Engineers  
Land Surveyors  
Landscape Architects  
Scientists

48 Constitution Drive  
Bedford, NH 03110  
Phone (603) 472-4488  
Fax (603) 472-9747  
www.tfmoran.com

TAX MAP 757 LOT 2B

**WORKOUT CLUB &  
WELLNESS CENTER**

**SOUTH PORTER STREET  
MANCHESTER, NH**

PREPARED FOR  
**STG REALTY ASSOCIATES, LLC**

FILE	17457.01	DATE	02-25-11
		CADFILE	17457-01 SITE

**SHEET 1 OF 2**

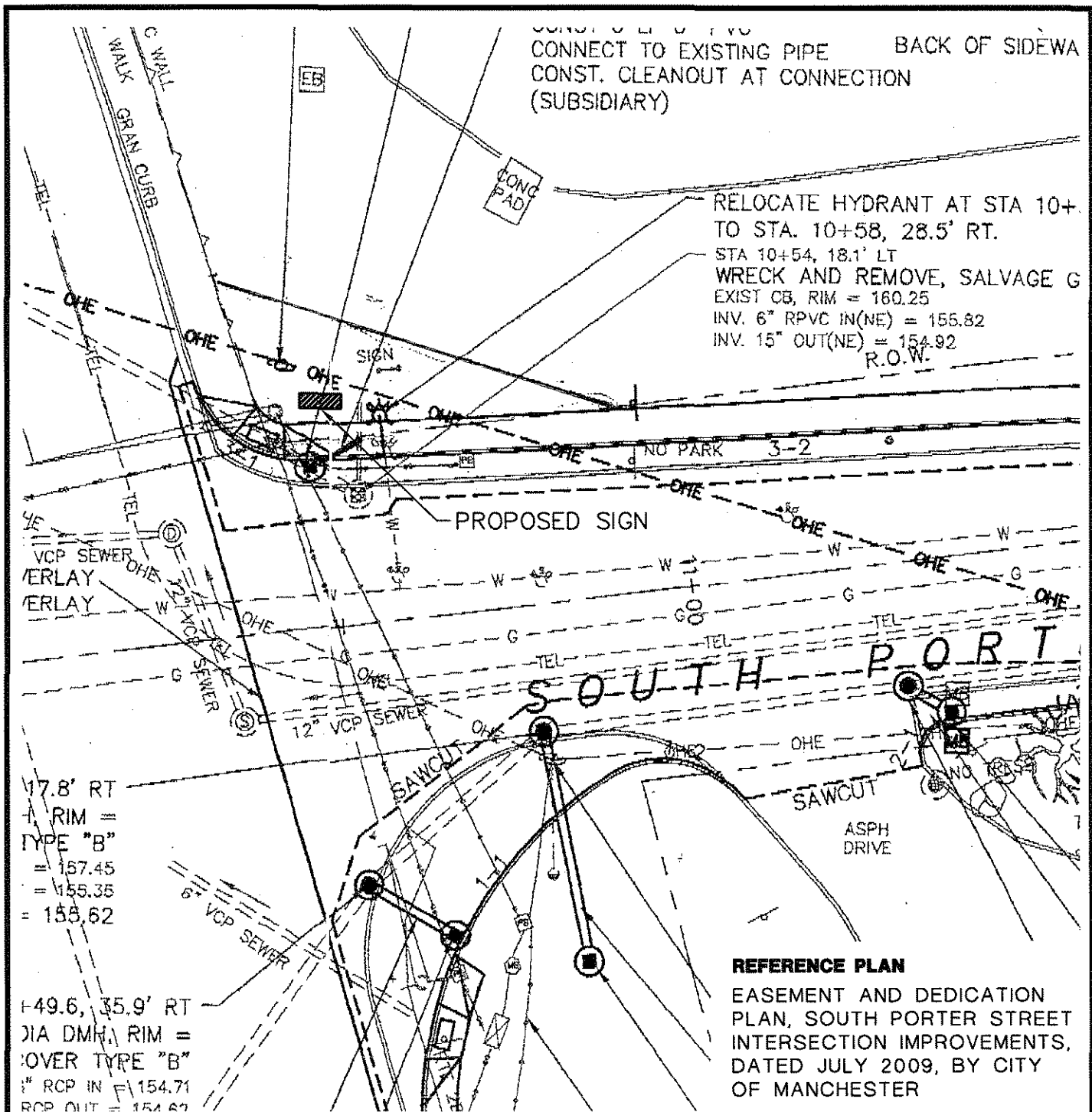

## SK-2 PROPOSED SIGN LOCATION - UTILITIES

SCALE: 1"=20'



Civil Engineers  
Structural Engineers  
Traffic Engineers  
Land Surveyors  
Landscape Architects  
Scientists

48 Constitution Drive  
Bedford, NH 03110  
Phone (603) 472-4488  
Fax (603) 472-9747  
www.tfmoran.com

TAX MAP 757 LOT 2B

**WORKOUT CLUB &  
WELLNESS CENTER**

**SOUTH PORTER STREET  
MANCHESTER, NH**

PREPARED FOR  
**STG REALTY ASSOCIATES, LLC**

FILE

17457.01

DATE

02-25-11

CADFILE

17457-01 SITE

SHEET 2 OF 2

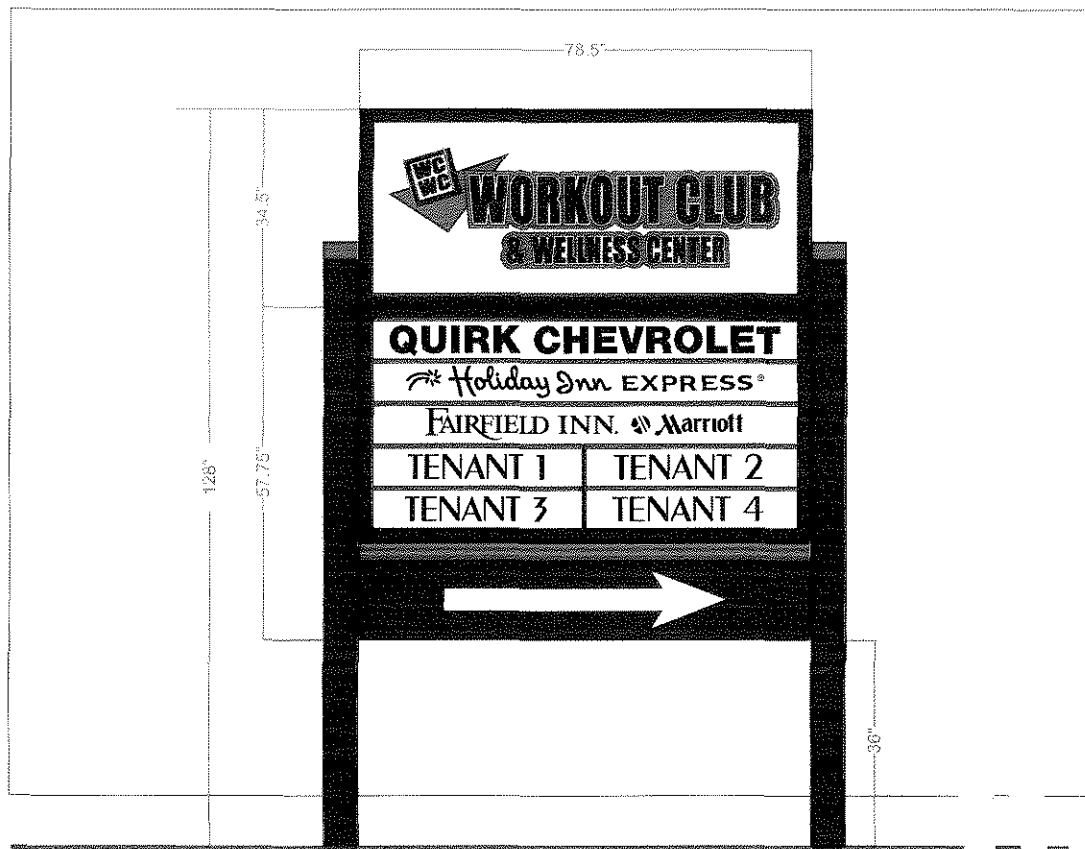

Scale: 3/8" = 1' 0"

50 Sq Ft

Concept B

Option 1.4

Furnish and install one double sided directional pylon sign.

This layout is conceptual only. All colors and measurements are subject to change and must be verified prior to production.

<b>CUSTOMER:</b> Workout Club & Wellness Center		
<b>CONTACT:</b> Ron Tringale	<b>W/O#:</b> 39487	<b>SALES REP:</b> JD Iles
<b>Option #:</b> as indicated	<input type="checkbox"/> s/t <input checked="" type="checkbox"/> d/t	
<b>Date:</b> 02/28/2011	<input checked="" type="checkbox"/> illum. <input type="checkbox"/> non illum.	
<b>Scale:</b> as indicated	<b>Cabinet/mold. Color:</b>	
<b>Colors:</b> see project colors	<b>G. Clearance:</b>	
<b>Seams:</b>	<b>Neon Color:</b>	
<b>Layout by:</b> CLR	<b>Face mat:</b>	
<b>File Name:</b> Workout Club & Wellness Ctr. 39487 / pylon	<input checked="" type="checkbox"/> Flat <input type="checkbox"/> Flex <input type="checkbox"/> Pan	

#### Project Colors:

<input type="checkbox"/>	TBD	<input type="checkbox"/>	<input type="checkbox"/>
<input type="checkbox"/>		<input type="checkbox"/>	<input type="checkbox"/>

*This print is conceptual only, see specs for actual colors.*

Copyright © 2011 Jutras Signs, Inc.  
This drawing, including graphic layout and technical detail is the property of Jutras Signs, Inc. and cannot be reproduced, copied or used without the prior express written permission of Jutras Signs Inc. All rights reserved.

**JUTRAS**  
SIGNS AND FLAGS  
30 Harvey Rd  
Bedford  
N.H. 03110  
622-2344

► **Approved By:**

**Date:**



CRAIG,  
DEACHMAN  
& AMANN

ATTORNEYS AT LAW

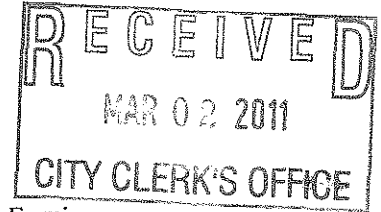

W. John Deachman, Esquire  
[jdeachman@cda-law.com](mailto:jdeachman@cda-law.com)

March 2, 2011

Alderman Jim Roy, Chairman  
c/o Matthew Normand, City Clerk  
Office of the City Clerk  
Committee on Public Health, Safety and Traffic  
One City Hall Plaza  
Manchester, NH 03101

Re: Objection to Proposed Sign at South Porter Street and South Willow Street

Dear Mr.Chairman,

This office represents June Seventh, LLC, owner of the real estate located at the corner of South Porter Street and South Willow Street where the Quirk Automotive Dealership is located.

I am writing to express my client's stern objection to the proposed sign for the Work Out Club to be located on City land adjacent to South Porter Street. Some members of the Committee may recall that my client donated this land to the City as an accommodation to the Highway Department to improve the intersection of South Porter Street and South Willow Street. The proposed sign, if erected, will obstruct the view of my client's property and obscure an existing sign my client maintains for his own business.

The proposed sign is a direct violation of Article 9.07, Parts C and D of the Manchester Zoning Ordinance. Part C prohibits signs on corner lots within 30 feet along curb lines from the point of intersection. The proposed sign is well within this prohibited zone. Part D prohibits signs on public lands that are not erected by or on behalf of a governmental body.

The Work Out Club had previously asked my client for permission to erect the sign on its land. My client politely declined for the reasons stated above. Had my known that the City intended to entertain a proposal to erect private signs on the land he generously donated, he never would have done so.



Page Two

March 2, 2011

Re: Objection to Proposed Sign at South Porter Street and South Willow Street

Kindly enter this objection in to the record. I also respectfully request that we are afforded an opportunity to provide additional testimony at the March 7, 2011 hearing, if necessary.

Thank you for your consideration.

Sincerely,

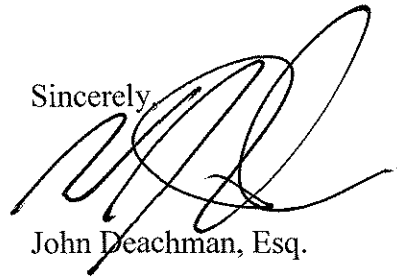
A handwritten signature in black ink, appearing to read 'J. Deachman', with a large, stylized flourish at the end.

John Deachman, Esq.

WJD/bms

Cc: Client

**COMMERCIAL MOTOR VEHICLE.** A vehicle designed or used to transport passengers or property if:

- (1) The vehicle has a gross vehicle weight rating or gross combination weight rating of 26,001 or more pounds; or
- (2) The vehicle is designed to transport more than 15 passengers including the driver; or
- (3) The vehicle is of any size and is used in the transportation of materials found to be hazardous pursuant to R.S.A. 259:12-3(c); or
- (4) The vehicle is used primarily for business and industry as contrasted with pleasure vehicles.
- (5) *Exclusion.* **COMMERCIAL MOTOR VEHICLE** shall not include a city vehicle, or emergency vehicles engaged in the provision of emergency medical, Police or Fire services.

In Board of Mayor and Aldermen

Date: 12/07/10

On motion of Ald. Roy

Seconded by Ald. Long

Voted to refer the discussion regarding a revised ordinance proposal related to commercial motor vehicles to the Committee on Public Safety, Health and Traffic.

 City Clerk

## **COMMERCIAL MOTOR VEHICLE**

### **CURRENT ORDINANCE:**

**COMMERCIAL MOTOR VEHICLE:** A vehicle designed or used to transport passengers or property if:

- (1) The vehicle has a gross vehicle weight rating or gross combination weight rating of 26,001 or more pounds; or
- (2) The vehicle is designed to transport more than 15 passengers including the driver; or
- (3) The vehicle is of any size and is used in the transportation of materials found to be hazardous pursuant to R.S.A. 259:12-3(c); or
- (4) The vehicle is used primarily for business and industry as contrasted with pleasure vehicles.
- (5) Exclusion. COMMERCIAL MOTOR VEHICLE shall not include a city vehicle, or emergency vehicles engaged in the provision of emergency medical, Police or Fire services.

### **DEFINITIONS**

**CURB WEIGHT** – The weight of a fueled automobile with standard equipment but without cargo or passengers.

**GROSS VEHICLE WEIGHT RATING (GVWR)** – The maximum allowable total weight of a road vehicle or trailer that is loaded, including the weight of the vehicle itself plus fuel, passengers, cargo, and trailer tongue weight.

### **FORD FOCUS**



**CURB WEIGHT – 2,840 lbs.  
GVWR – 3,825 lbs.**

### **FORD ESCAPE**



**CURB WEIGHT – 3,387 lbs.  
GVWR – 4,520 lbs.**

## **FORD EXPLORER**



**CURB WEIGHT – 4,531 lbs.**  
**GVWR – 6,051 lbs.**

## **FORD F150**

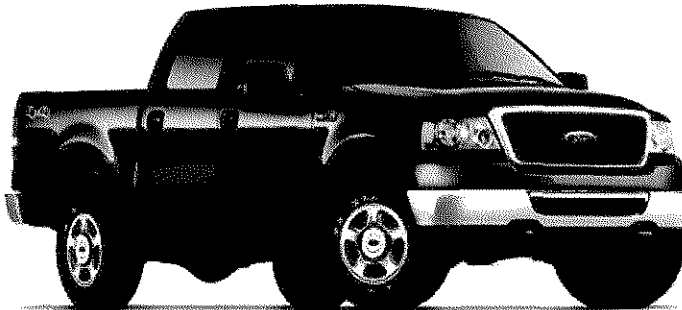

**CURB WEIGHT – 4,904 lbs.**  
**GVWR – 6,744 lbs.**

## **FORD F450**



**CURB WEIGHT – 8,290 lbs.**  
**GVWR – 14,500 lbs.**

### **FORD E-150 VAN**

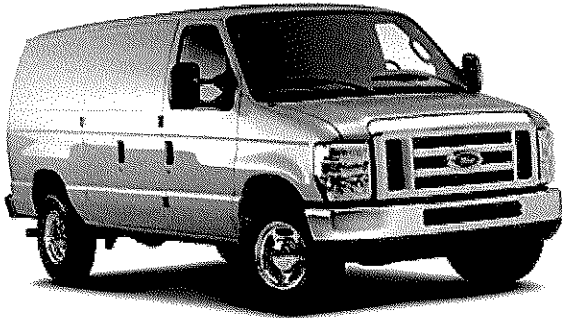

**CURB WEIGHT – 5,186 lbs.  
GVWR – 14,500**

### **FORD F750 DUMP TRUCK**



**GVWR – 33,000**

**Note: Both curb weights and gross vehicle weights vary depending on vehicle model, trim and options. The numbers presented are an average for that vehicle type.**

## Truck Class Definitions



**Commercial Light Duty Trucks** - Examples: Minivan, Utility Van, Multi-Purpose, Pickup, Mini-Bus, Step Van.

Where the Gross Vehicle Weight is:

Class 1 (Gvw 0 - 6000)

Class 2 (Gvw 6001 - 10000)

Class 3 (Gvw 10001 - 14000)



**Medium Duty Trucks** - Examples: City Delivery, Large Walk-in, Bucket, Landscaping.

Where the Gross Vehicle Weight is:

Class 4 (Gvw 14001 - 16000)

Class 5 (Gvw 16001 - 19500)

Class 6 (Gvw 19501 - 26000)



**Heavy Duty Trucks** - Examples: Refuse, Tow, City Bus, Furniture, Conventional, COE, Fuel, Fire Engine, Refrigerated, Dump, Cement.

Where the Gross Vehicle Weight is:

Class 7 (Gvw 26001 - 33001)

Class 8 (Gvw 33001 - 150000)



**Trailers** - Examples: Auto Transporter, Logger, Low Boy, Dump, Platform, Drop Frame, Doubles



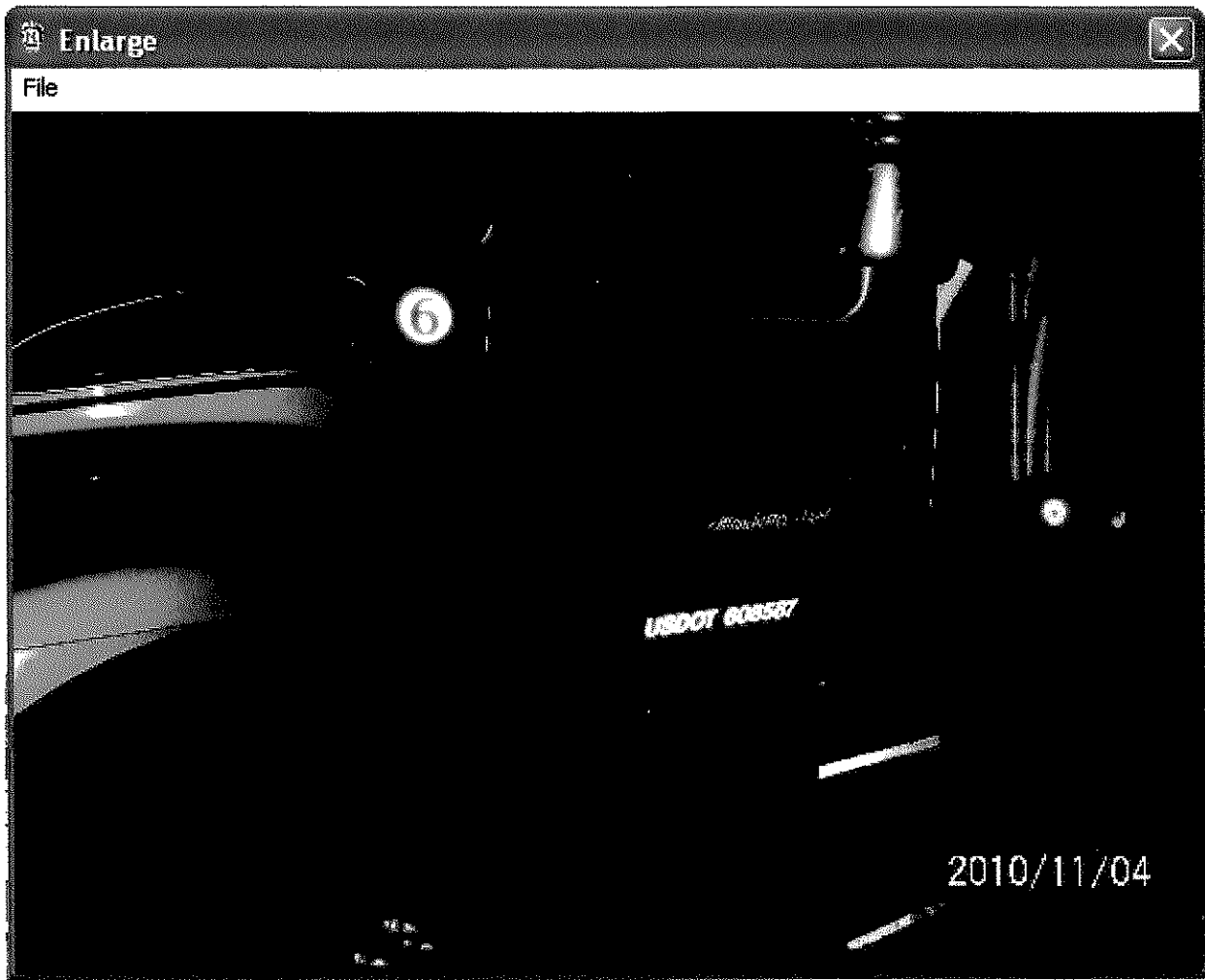

flat bed tow truck



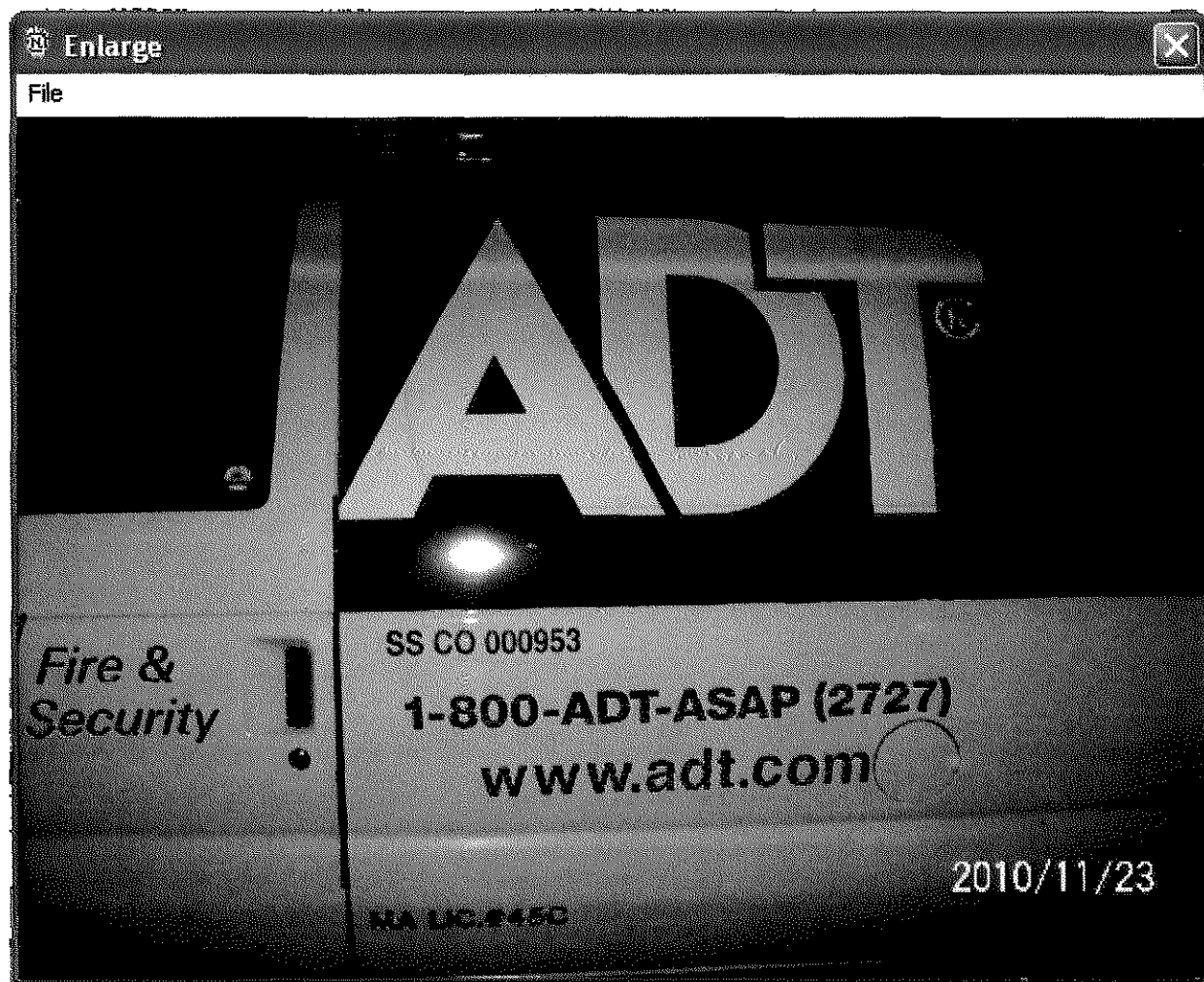



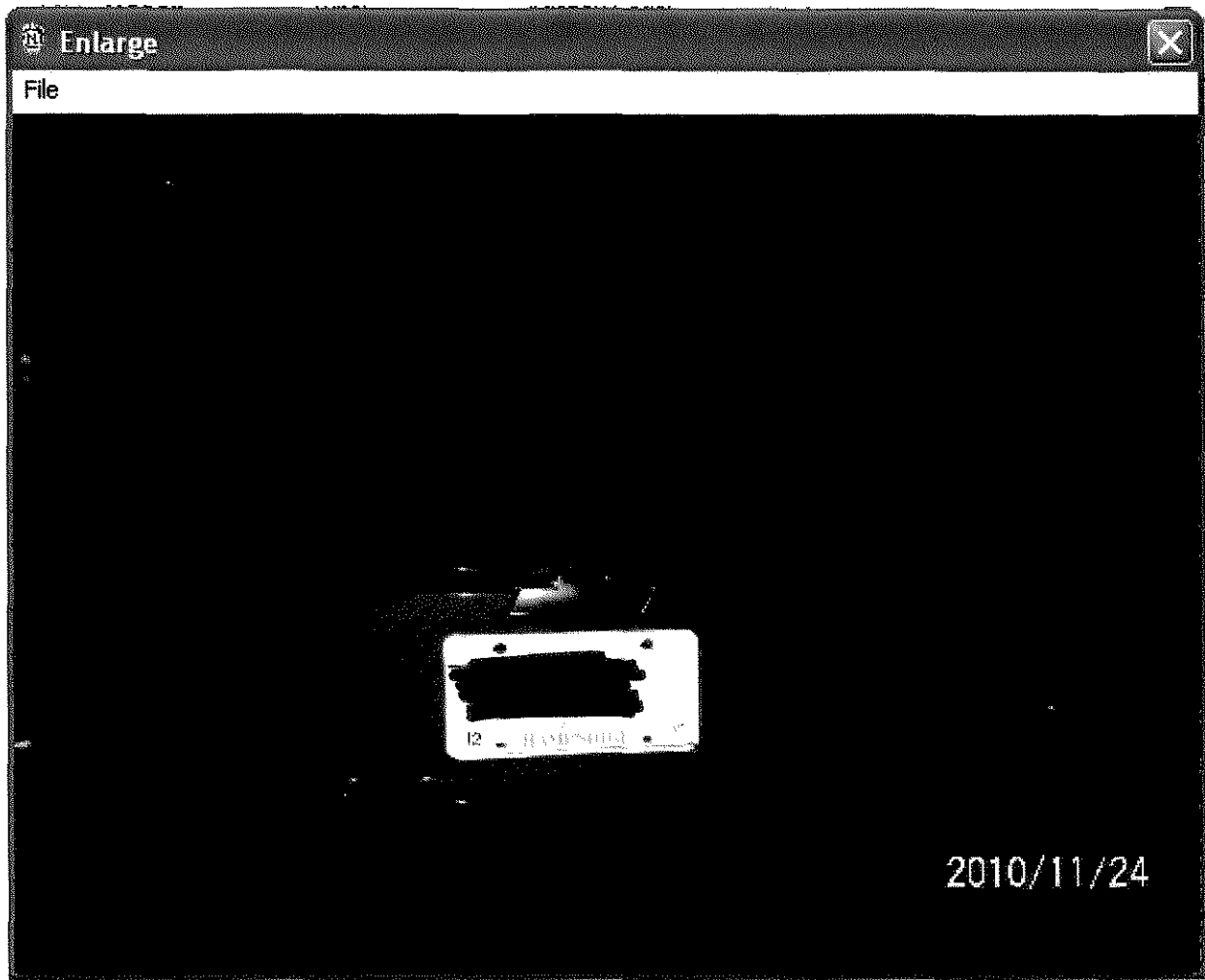

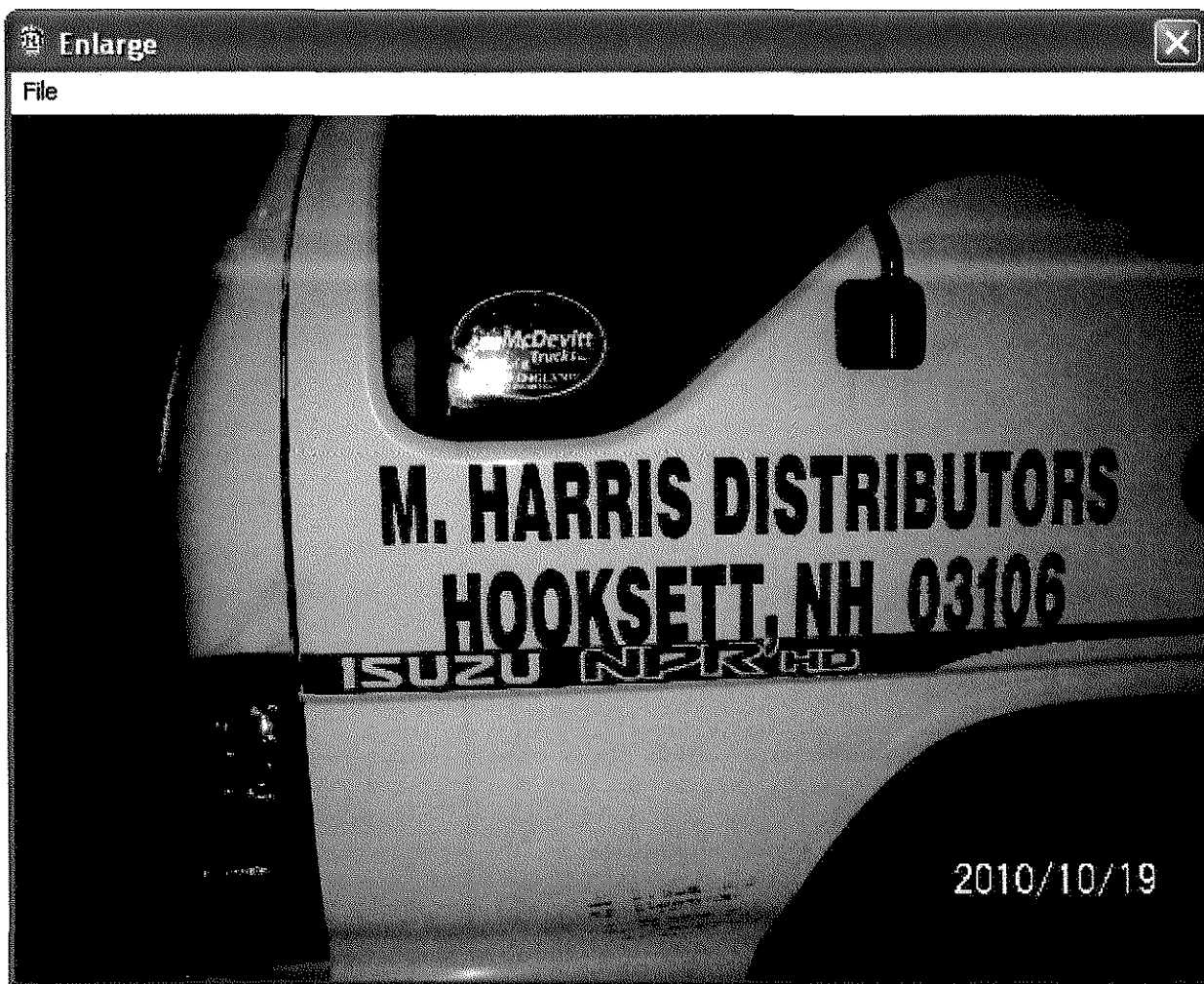

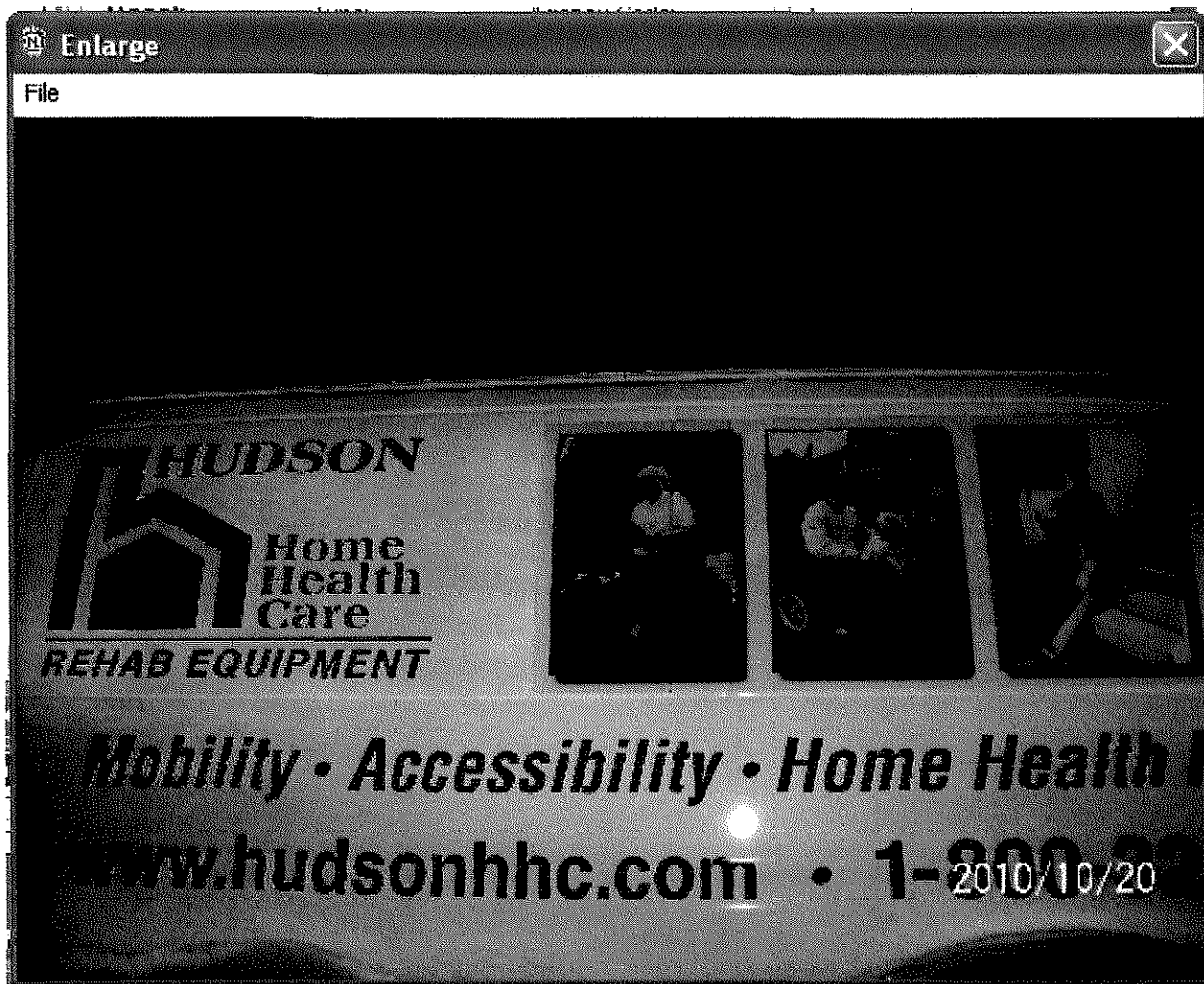





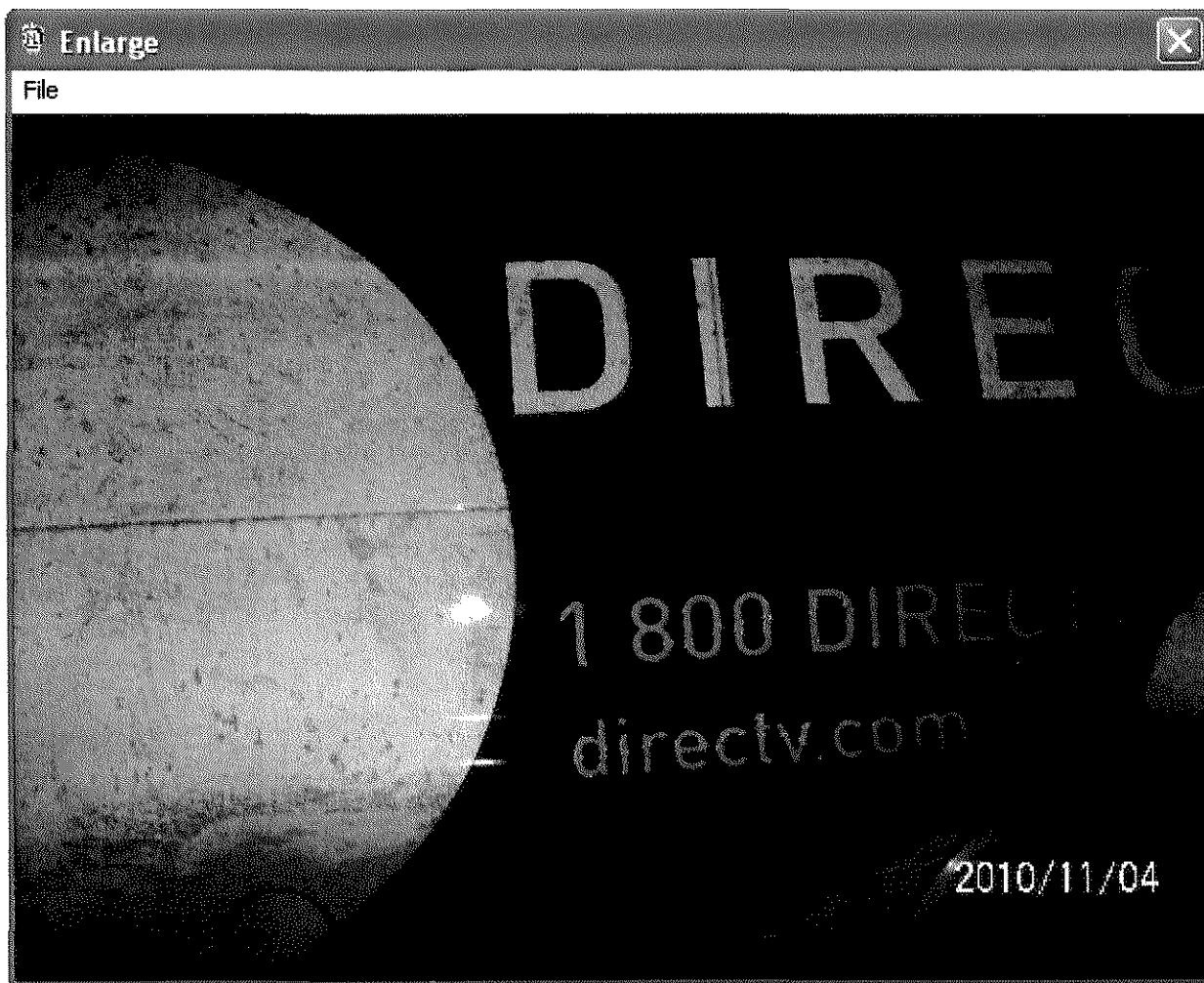











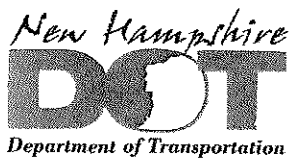

THE STATE OF NEW HAMPSHIRE  
DEPARTMENT OF TRANSPORTATION

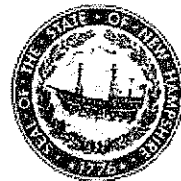

GEORGE N. CAMPBELL, JR.  
COMMISSIONER

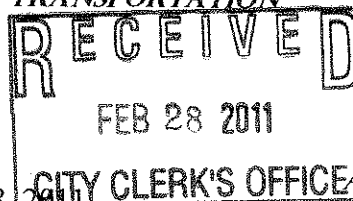

JEFF BRILLHART, P.E.  
ASSISTANT COMMISSIONER

February 18, 2011

James P. Hoben  
Deputy Director of Traffic  
City of Manchester  
480 Hayward Street  
Manchester, NH 03103

Re: Candia Road at I-93 Exit 6 SB on-ramp & SB Connector Road  
Manchester, New Hampshire

Dear Mr. Hoben:

Pursuant to a request from your office, initiated by a citizen inquiry, the Bureau of Traffic has completed an extensive evaluation at the signalized intersection of Candia Road at the I-93 Exit 6 SB on-ramp & SB Connector Road. It should be noted that NHDOT maintains the traffic signals at this intersection, and is also responsible for maintenance on the SB Connector Road and Exit 6 SB on-ramp. Candia Road is maintained by the City of Manchester.

Your specific request was that our office investigate whether or not the southbound Connector Road two-lane approach (shared through/left-turn lane and an exclusive right-turn lane) could be re-stripped and/or receive additional green time allocation, so as to process traffic more efficiently.

To that end, the Bureau's evaluation included the following: a site inspection by engineering staff; the collection of weekday morning and weekday evening peak period intersection turning movement count data (provided by the Southern NH Planning Commission); and a subsequent analysis of current traffic operations at this location, from a capacity, delay, and queue length perspective.

The intersection of Candia Road at the I-93 Exit 6 SB on-ramp & SB Connector Road is part of a coordinated signal system, which includes the I-93 Exit 6 NB off-Ramp & NB Connector Road, also under NHDOT jurisdiction. This coordination effort was completed by NHDOT in 2008, in conjunction with the \$12.8m Candia Road project (NHDOT Project No. 12328). Accordingly, any potential modification at the SB on-ramp intersection must also be evaluated simultaneously with the NB off-ramp intersection, in order to ensure that the substantial investment made by NHDOT at these locations is preserved.

Based on existing volumes and signal timings, our capacity analysis demonstrates that, overall, these intersections are functioning well below capacity ( $v/c < 0.84$ ) during all analysis periods and operating with acceptable levels of delay and attendant levels-of-service (LOS C).

In order to assess the most appropriate alternative for possible intersection enhancements at the intersection of Candia Road at the I-93 Exit 6 SB on-ramp & SB Connector Road, NHDOT considered both timing modifications, and the approach geometry suggested by the citizen inquiry, specifically, re-striping the SB approach to provide for an exclusive left-turn lane and a shared through/right-turn lane.

While there is a certain degree of merit to each alternative, they are not without their respective downsides. Timing modifications (adding green time) to the SB Connector Road approach will reduce delays and queuing; however, this inherently takes time away from the mainline (Candia Road), which hinders the coordinated system as a whole. Re-striping the SB approach to provide for an exclusive left-turn lane and a shared through/right-turn lane will reduce delays and queuing for the innermost travel lane, but that burden will be shifted to the outermost travel lane, and our office does not see that as a viable alternative.

Although not suggested in your prior correspondences, a subsequent analysis performed by the Bureau of Traffic reveals that an additional SB approach lane, with attendant changes in geometry to provide for exclusive left, through, and right-turn lanes, will provide the best overall results. A preliminary review of record plans indicates that this improvement could most likely be accomplished within the existing public right-of-way, with minor modifications to signal equipment (location of pull boxes, longer mast arms, etc.).

While NHDOT understands that your office may be seeking to implement a solution immediately, funding for a geometric improvement is not possible this construction season. We will add this intersection to our list for future State Betterment work, to be completed as funding is available.

Our office would be more than happy to speak with you in more detail about any of these options. In the interim, if you have any questions, please contact Robert Bollinger or me at 271-2291 for further assistance.

Sincerely,

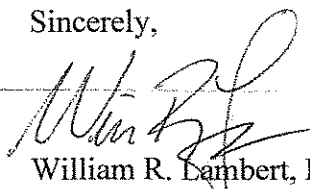

William R. Lambert, P.E.  
Traffic Engineer/Administrator

WRL/REB

cc: L. Knowlton, NHDOT Director of Operations  
P. Mitchell, NHDOT District 5  
File

S:\TOWNFILE\Manchester\Signals\11\_0218 Lambert to J. Hoben.doc

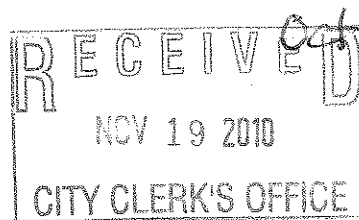

Oct 19, 2010  
12/6/10 Tabled

Mayor Ted Gatsas,

First and foremost "Thanks" for doing such a wonderful job and being so involved in getting the City of Manchester heading in the right direction. As much as we'd miss you in Manchester, maybe you should have run for Governor so you and Lou D'Allesandro could straighten out New Hampshire.

I was going to attend your open-forums meeting Monday night, October 18, 2010 but wasn't sure if the enclosed would be in order. My main concern is the area within the red area. On weekdays from 7AM-9:30AM and 3:00 PM-6:00 PM this area is very congested. If I can be of any further assistance or you have any questions please feel free to call.

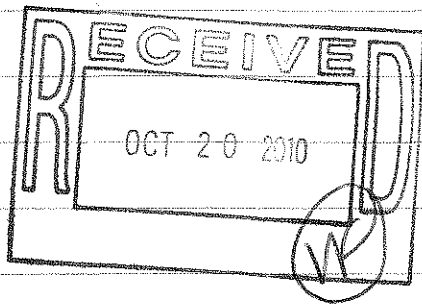

Thank you,  
Joseph M. Parrotto  
Parrotto

64 Beaver St.  
Manchester, N.H. 03104  
(603) 623-2749 or 318-6911

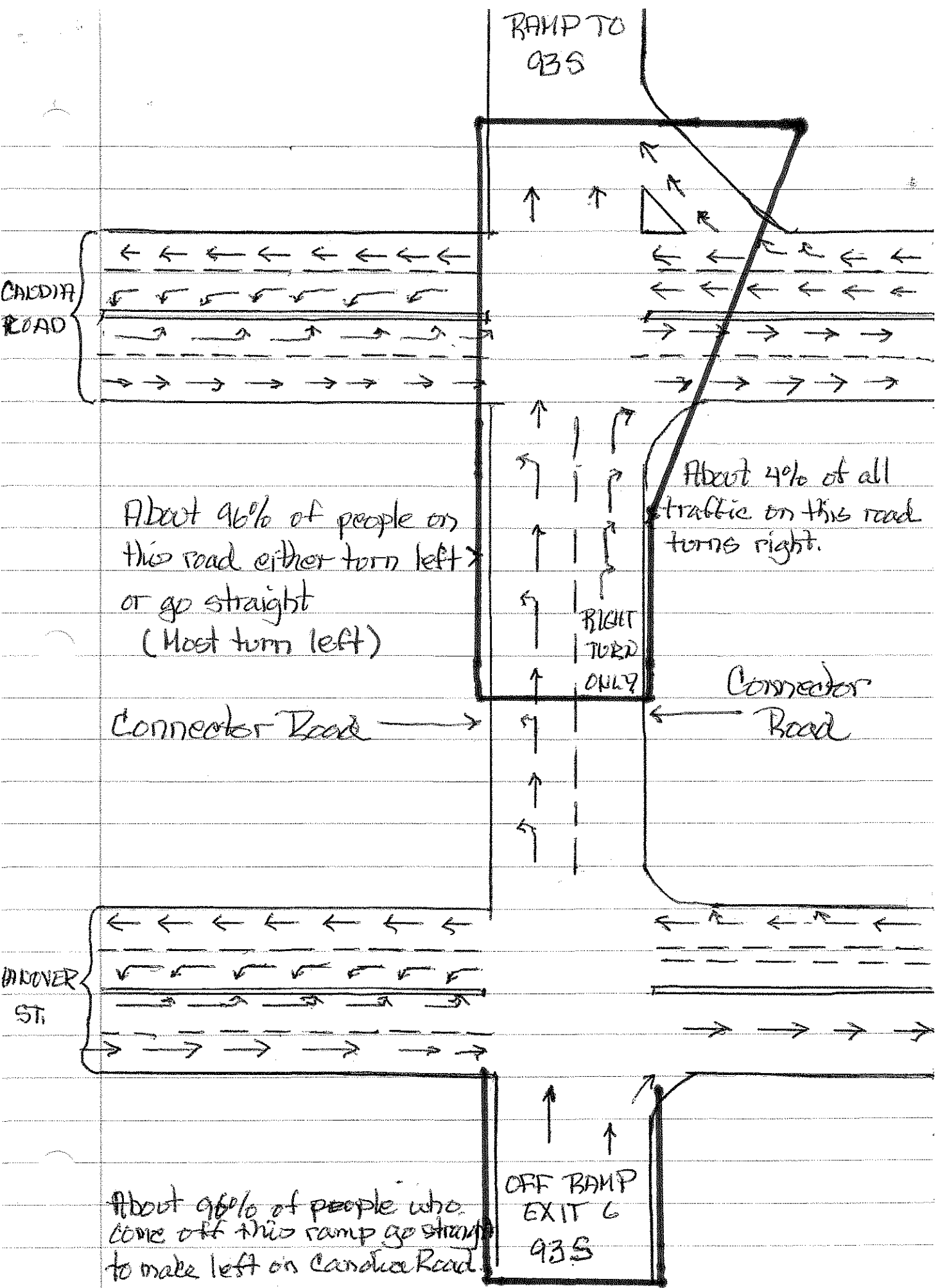



① Most people coming off ramp at Exit 6 93 South go straight at intersection with Hanover St, and make left turn on Candia Road to head toward Industrial Drive.

② Traffic light at intersection of connector road and Candia Road only stays green on connector road side long enough to allow 4 or 5 vehicles to get through before turning red. After sitting through 2 or 3 red lights people starting to have an anxiety attack get in "right hand turn only" lane. Now when light turns green you have three vehicles (2 from connector road and 1 from Candia Road) trying to get up ramp to 93 South. I have sat through 5 red lights at 4:15 PM to get from connector road to ramp to 93 South.

#### POSSIBLE SOLUTIONS:

1. Extend time light stays green on connector side of intersection (OR)
2. Remove "Right Hand Turn Only" Signs and remove road to be right hand turn +/or straight ahead to ramp and make left lane a "left Turn Only" lane.

Personally I feel solution #2 would be the most efficient as very few vehicles make this right hand turn considering amount of traffic at this intersection.